

Oregon Parks and Recreation Commission

September 18, 2024

Agenda Item: **7b** **Action**

Public Comment Allowed: **Yes**

Topic: **Silver Falls South Loop Campground Paving Restoration**

Presented by: **Rob Morris, Engineering Lead**

Background:

- Staff requests approval for awarding a construction contract for the Silver Falls South Loop Campground Paving Restoration project.
- Scope will include restoring the roadways, campsites, pathways and improving accessibility within the A loop and sections of the B loop.

Project Manager: John Seevers, Construction Project Manager

Project Number: 37398

Project Budget: \$800,000 to \$1,000,000 (Pending construction bid proposals)

Prior Action by Commission: None

Action Requested: Approval to execute a construction contract with a value not to exceed \$1M

Attachments: 7b Attachment A Silver Falls South Campground Paving Map

Prepared by: John Seevers, Construction Project Manger

Silver Falls State Park

20024 Silver Falls Hwy SE, Sublimity OR 97385 • 503-873-8681

Reservations: 800-452-5687
stateparks.oregon.gov

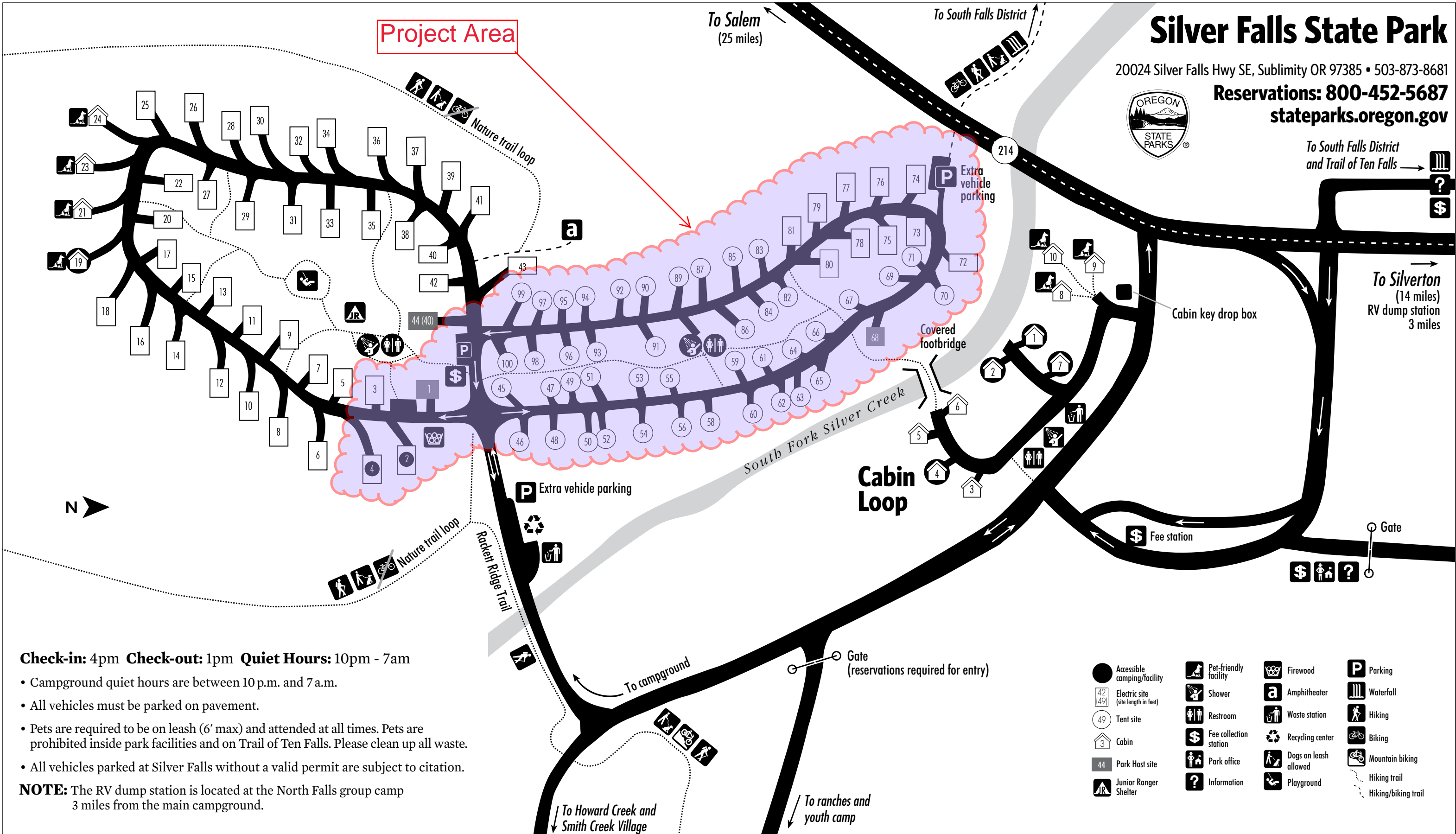

Check-in: 4pm Check-out: 1pm Quiet Hours: 10pm - 7am

- Campground quiet hours are between 10 p.m. and 7 a.m.
- All vehicles must be parked on pavement.
- Pets are required to be on leash (6' max) and attended at all times. Pets are prohibited inside park facilities and on Trail of Ten Falls. Please clean up all waste.
- All vehicles parked at Silver Falls without a valid permit are subject to citation.

NOTE: The RV dump station is located at the North Falls group camp 3 miles from the main campground.

Accessible camping/facility	Pet-friendly facility	Firewood	Parking
Electric site (site length in feet)	Shower	Amphitheater	Waterfall
Tent site	Restroom	Waste station	Hiking
Cabin	Fee collection station	Recycling center	Biking
Park Host site	Park office	Dogs on leash allowed	Mountain biking
Junior Ranger Shelter	Information	Playground	Hiking trail
			Hiking/biking trail

90% DELIVERABLE

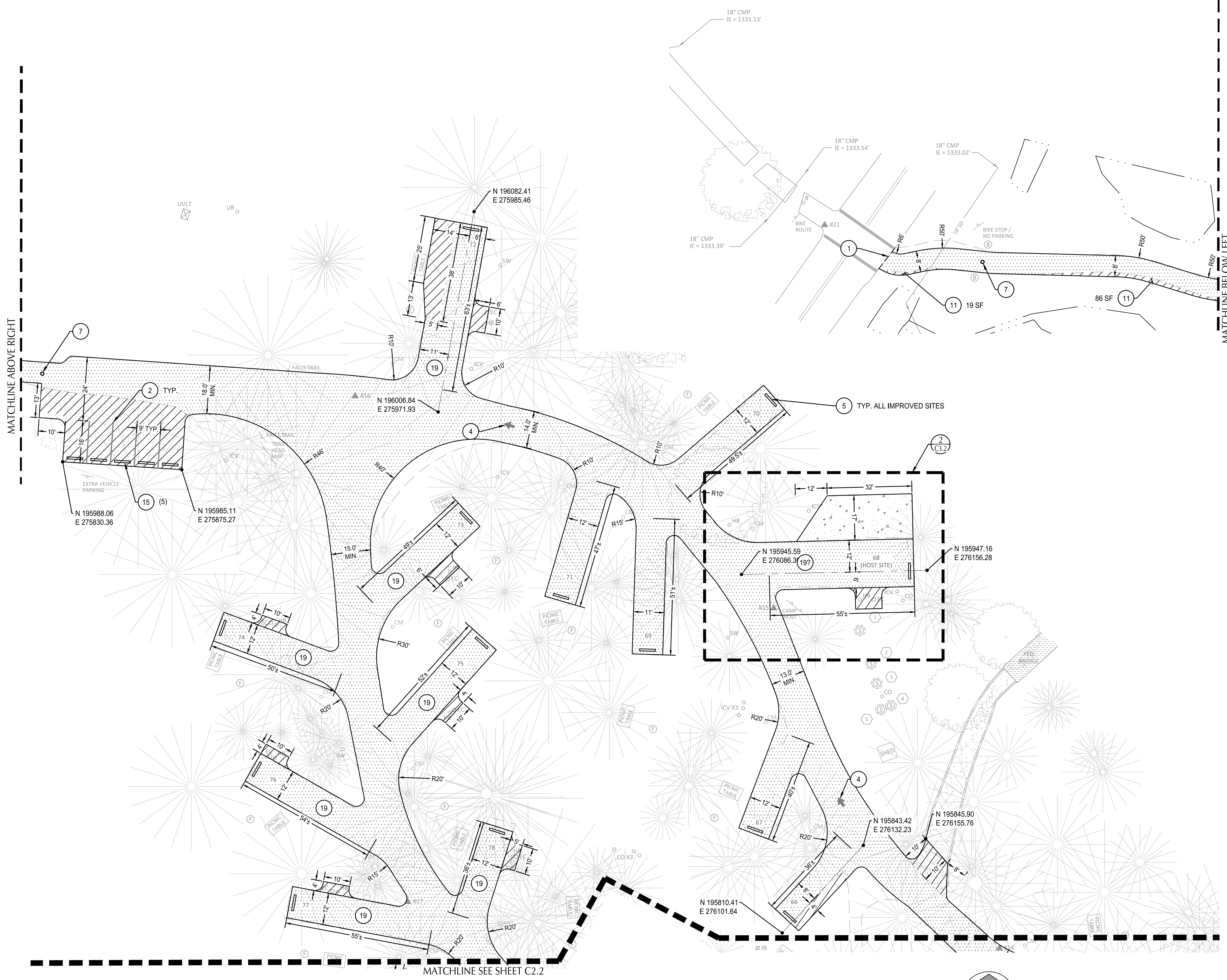

SHEET NOTES

1. ALL DIMENSIONS ARE TO EDGE OF ASPHALT UNLESS NOTED OTHERWISE. ALL CAMPSITE LENGTH DIMENSIONS ARE FROM EDGE OF ROAD.
2. SMALL RADII ARE 3', UNLESS NOTED OTHERWISE.
3. NATIVE SURFACE RESTORATION SHALL CONSIST OF A COMBINATION OF RYE GRASS AND FINE FESCUES OR EQUIVALENT. IF POTENTIAL CULTURAL RESOURCES ARE DISCOVERED DURING THE COURSE OF WORK, CONTRACTOR SHALL STOP WORK IMMEDIATELY AND REPORT THE DISCOVERY TO THE PARK MANAGER AND OWNER'S PROJECT MANAGER.
4. ROAD RESTORATION TO BE CONSTRUCTED PER DETAIL 1/C5.1.
5. ALL SITES ARE STANDARD TENT SITES UNLESS NOTED OTHERWISE. SEE DETAIL 3/C5.1.

(X) SITE KEY NOTES

#	DESCRIPTION	DETAIL REF.
1	SAWCUT LINE	
2	4" WHITE LINE	6/C5.0
3	12" WHITE THERMOPLASTIC STOP BAR	6/C5.0
4	DIRECTIONAL ARROW	6/C5.0
5	INSTALL CAMPSITE WHEEL STOP	2/C5.2
6	TWO 4" YELLOW LINES	6/C5.0
7	BOLLARD	1/C5.2
8	MITIGATE ROOT INTRUSION. PRIOR TO PAVING. CONTRACTOR TO FILL AREA WITH BASE ROCK UNTIL TOP OF ROCK IS EQUAL TO TOP OF ROOT.	
9	SET SALVAGED BOULDERS ON NEW ASPHALT.	4/C5.2
10	INSTALL AREA DRAIN, CONNECT TO EXISTING PIPE	2B/C5.0
11	CONSTRUCT TYPICAL ASPHALT PAVEMENT	
12	REINSTALL SALVAGED SITE MARKER	
13	ADA PARKING STALL AND STRIPING	8/C5.0
14	ADA PARKING SIGN	7/C5.0
15	INSTALL PARKING WHEEL STOP	
16	CONTRACTOR TO INSTALL GRAVEL PAVING UNDER EXISTING SHADE STRUCTURE.	
17	CONTRACTOR TO INSTALL ASPHALT PAVING UNDER EXISTING SHADE STRUCTURE.	
18	CONNECT TO EXISTING PAVEMENT.	
19	CONSTRUCT STANDARD RV SITE.	2/C5.1
20	CONSTRUCT ACCESSIBLE RV SITE.	4/C5.1
21	CONSTRUCT ACCESSIBLE TENT SITE.	5/C5.1

SHEET LEGEND

	WETLAND BOUNDARY	
	SAWCUT LINE	
	ASPHALT ON EXISTING BASE ROCK	1A (C5.0)
	HEAVY ASPHALT ON EXISTING BASE ROCK	1B (C5.0)
	PEDESTRIAN ASPHALT PAVEMENT	2A (C5.0)
	TYPICAL ASPHALT PAVEMENT	2B (C5.0)
	HEAVY ASPHALT PAVEMENT	2C (C5.0)
	GRAVEL PAVING	3 (C5.0)
	CONCRETE PAVING	4 (C5.0)

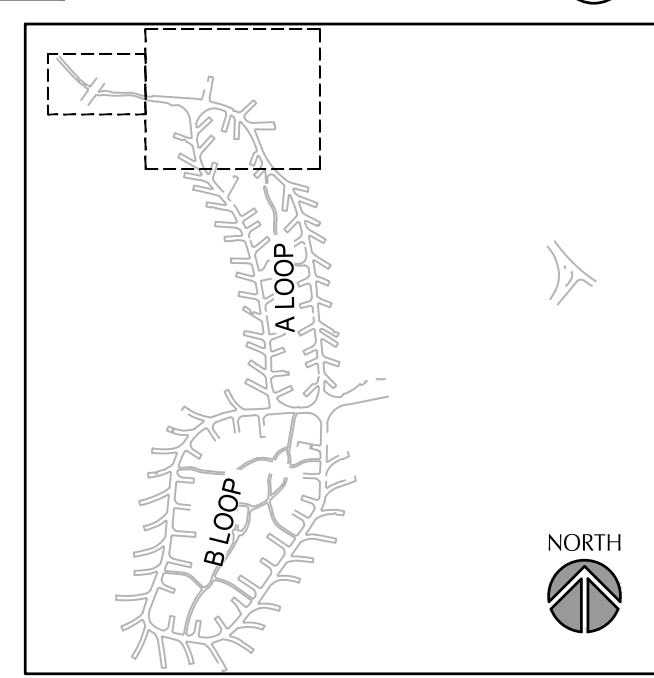

111 SW Fifth Ave., Suite 2400
Portland, OR 97204
O: 503.227.3251
F: 503.274.4681
www.kpff.com

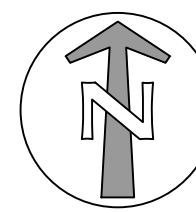
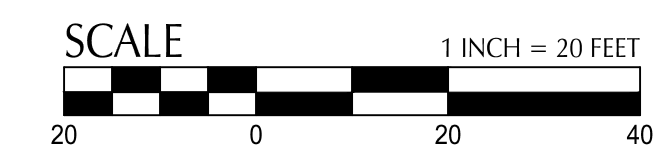

REVISION	DATE	BY

APPROVED BY	JZ
CHECKED BY	CV
DESIGNED BY	LB/DM
DRAWN BY	RC
DATE	JULY 2024

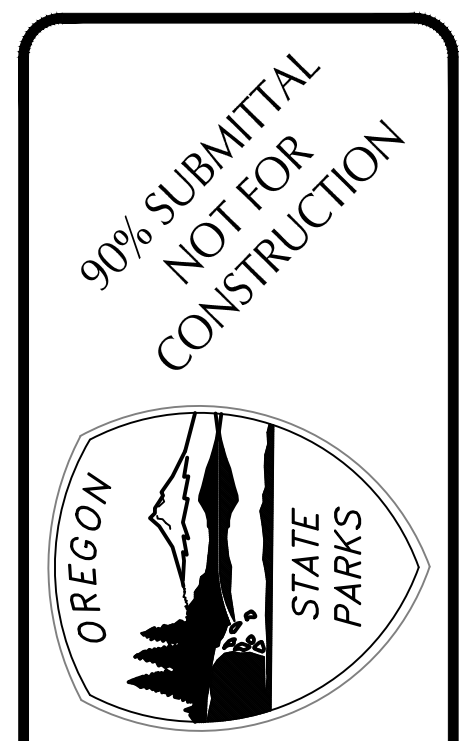

SITE AND PAVING PLAN
 CAMPGROUND A LOOP PAVING
 SILVER FALLS STATE PARK
 OREGON PARKS AND RECREATION DEPARTMENT

SHEET:	C2.1
OPRIS#:	37398
CONTRACT #:	11738

File: N:\c\p\2023\2300315-oprd-sf-sp-road\CAD\PILOT\23315-20-SITE.dwg TAB: C2.1
 Plotted: 7/12/24 at 4:38pm By: LBurke

90% DELIVERABLE

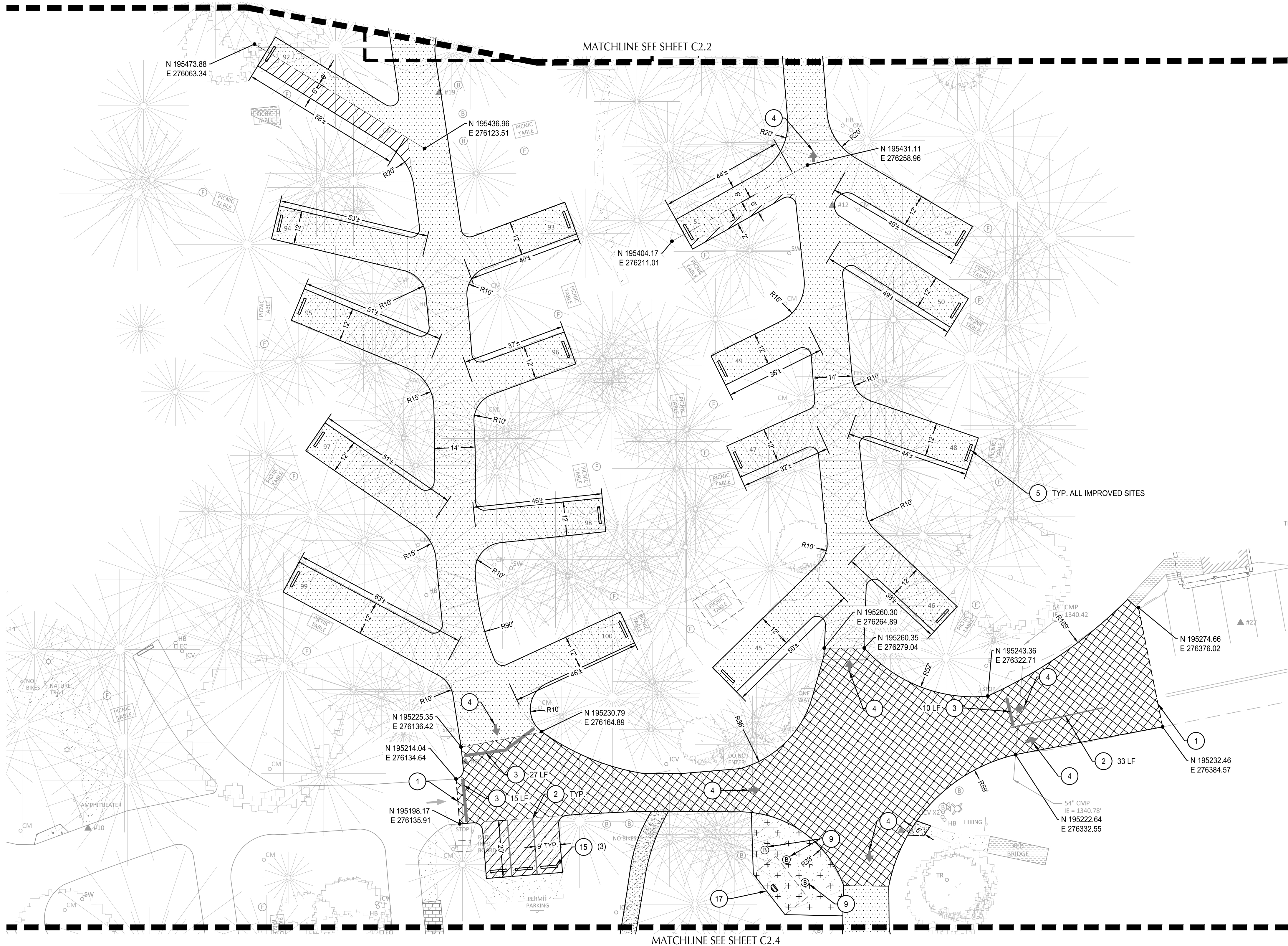

SHEET NOTES

- ALL DIMENSIONS ARE TO EDGE OF ASPHALT UNLESS NOTED OTHERWISE. ALL CAMPSITE LENGTH DIMENSIONS ARE FROM EDGE OF ROAD.
- SMALL RADII ARE 3', UNLESS NOTED OTHERWISE.
- NATIVE SURFACE RESTORATION SHALL CONSIST OF A COMBINATION OF RYE GRASS AND FINE FESCUES OR EQUIVALENT. IF POTENTIAL CULTURAL RESOURCES ARE DISCOVERED DURING THE COURSE OF WORK, CONTRACTOR SHALL STOP WORK IMMEDIATELY AND REPORT THE DISCOVERY TO THE PARK MANAGER AND OWNER'S PROJECT MANAGER.
- ROAD RESTORATION TO BE CONSTRUCTED PER DETAIL 1/C5.1. ALL SITES ARE STANDARD TENT SITES UNLESS NOTED OTHERWISE. SEE DETAIL 3/C5.1.

SITE KEY NOTES

#	DESCRIPTION	DETAIL REF.
1	SAWCUT LINE	
2	4" WHITE LINE	6/C5.0
3	12" WHITE THERMOPLASTIC STOP BAR	6/C5.0
4	DIRECTIONAL ARROW	6/C5.0
5	INSTALL CAMPSITE WHEEL STOP	2/C5.2
6	TWO 4" YELLOW LINES	6/C5.0
7	BOLLARD	1/C5.2
8	MITIGATE ROOT INTRUSION. PRIOR TO PAVING. CONTRACTOR TO FILL AREA WITH BASE ROCK UNTIL TOP OF ROCK IS EQUAL TO TOP OF ROOT.	
9	SET SALVAGED BOULDERS ON NEW ASPHALT.	4/C5.2
10	INSTALL AREA DRAIN, CONNECT TO EXISTING PIPE	2B/C5.0
11	CONSTRUCT TYPICAL ASPHALT PAVEMENT	
12	REINSTALL SALVAGED SITE MARKER	
13	ADA PARKING STALL AND STRIPING	8/C5.0
14	ADA PARKING SIGN	7/C5.0
15	INSTALL PARKING WHEEL STOP	
16	CONTRACTOR TO INSTALL GRAVEL PAVING UNDER EXISTING SHADE STRUCTURE.	
17	CONTRACTOR TO INSTALL ASPHALT PAVING UNDER EXISTING SHADE STRUCTURE.	
18	CONNECT TO EXISTING PAVEMENT.	
19	CONSTRUCT STANDARD RV SITE.	2/C5.1
20	CONSTRUCT ACCESSIBLE RV SITE.	4/C5.1
21	CONSTRUCT ACCESSIBLE TENT SITE.	5/C5.1

SHEET LEGEND

	WETLAND BOUNDARY	
	SAWCUT LINE	
	ASPHALT ON EXISTING BASE ROCK	1A (C5.0)
	HEAVY ASPHALT ON EXISTING BASE ROCK	1B (C5.0)
	PEDESTRIAN ASPHALT PAVEMENT	2A (C5.0)
	TYPICAL ASPHALT PAVEMENT	2B (C5.0)
	HEAVY ASPHALT PAVEMENT	2C (C5.0)
	GRAVEL PAVING	3 (C5.0)
	CONCRETE PAVING	4 (C5.0)

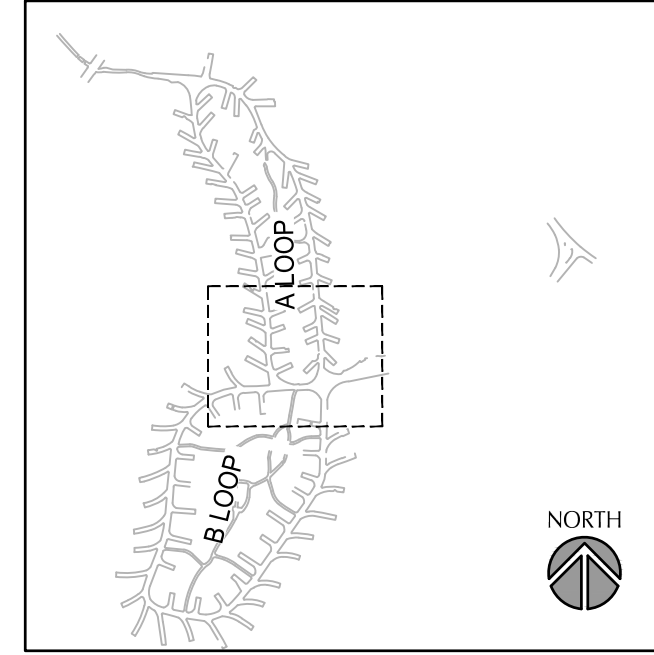

111 SW Fifth Ave., Suite 2400
 Portland, OR 97204
 O: 503.227.3251
 F: 503.274.4681
www.kpff.com

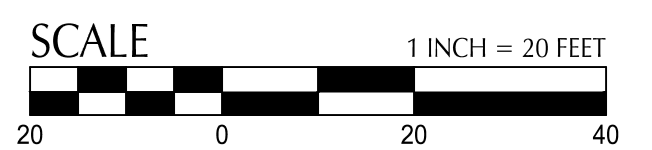
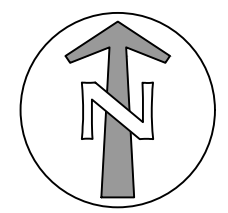

BY
DATE
REVISION

APPROVED BY	JZ
CHECKED BY	CV
DESIGNED BY	LB/DM
DRAWN BY	RC
DATE	JULY 2024

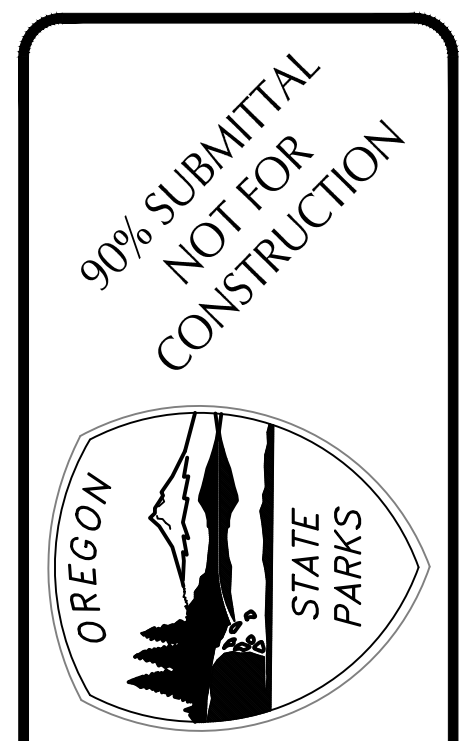

SITE AND PAVING PLAN
 CAMPGROUND A LOOP PAVING
 SILVER FALLS STATE PARK

OREGON PARKS AND RECREATION DEPARTMENT

SHEET:	C2.3
OPRIS#:	37398
CONTRACT #:	11738

