



Welcome to the New DTC Orientation!

Session 4

December 16, 2024

Welcome!

Please rename yourself to include your first and last name, your district, and your pronouns (if you wish).

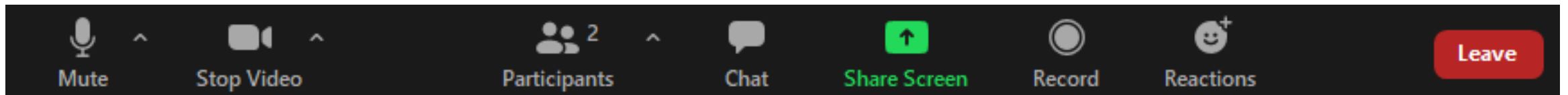
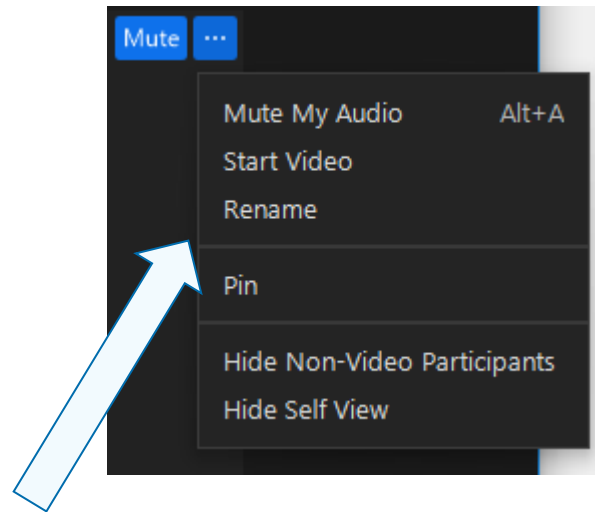

Activator



Image from Karaoke Stock Photos

Reminders

Reminders:

- January 15, 2025 “Advanced TIDE Functionality” Webinar, [register here](#)
- Read the TAM again . . .
- Familiarize yourself with the ODE website and OSAS Portal
- Communicate, communicate, communicate . . .

Introductions: Regional ESD Partners

Assessment Support:

Amy Rockwell, Regions 1 & 2

Shannon Lyon, Region 3

Data Collections/Accountability:

Karen Brown Smith

Peter Campbell

Joe Doherty

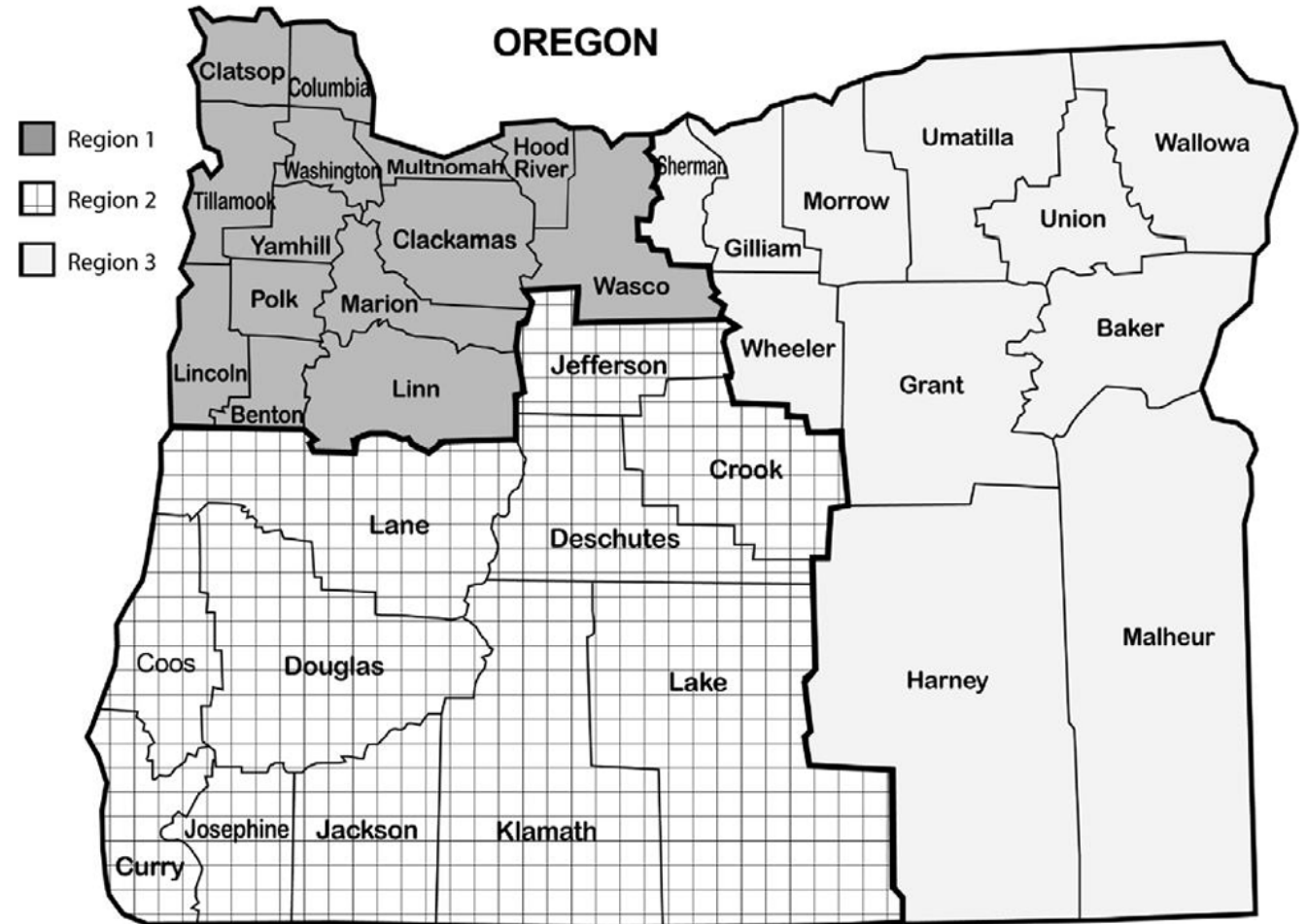

Schedule of Events

Date	Topics
10/28/24	Intros of Assessment Team members, ESD Partners, Mentor DTCs Overview of OSAS (and what it's not) "Before testing" section of Roadmap
11/18/24	"During testing": STC/TA training and accessibility
12/2/24	"During testing": opt-out process, improprieties, crisis alerts
12/16/24 (today!)	"After testing"
Winter / Spring 25	ESD Partners will present on topics of choice
01/15/25	Advanced TIDE Functionality – register here

School Year Test Administration

Before Testing

During Testing

After Testing

Aug Sept Oct Nov Dec Jan Feb Mar Apr May Jun Jul

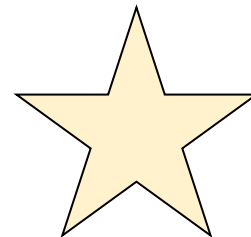

“After” Testing Topics

We recommend that DTCs...

- Merge Temporary IDs to SSIDs in TIDE.
 - You may begin this process now if you have any Temp IDs
- Complete Assessment Record Management in ARUA
 - If you don't work in the summer, please ensure someone else is assigned these tasks (test records are scheduled to load 3/17/25 to 7/11/25)
- Review Assessment-Related Validations in Achievement Data Insight Application
 - 6/12/25 to 8/22/25
- Distribute Official Individual Student Reports (ISR)
- Submit 2025-26 Annual DTC Designation form

“After” Testing Topics continued

Access is managed by your District Security Administrator
<https://district.ode.state.or.us/CentralLogin/DSASearch>

ODE Applications and Data Collections

- Assessment Transactional System (ARUA)
 - Test record management (correcting errors, entering opt-outs), looking up test records
- Secure Assessment Reports (SAR)
 - “Official” reports: Individual Student (ISR), Class Roster, Class Summary
- Achievement Data Insight (ADI)
 - Assessment Report Validations
- Accountability Warehouse Extract (AWE)

ODE District Data Site

Login the [Central Login application](#) found on the ODE District Data Site:

<https://odedistrict.oregon.gov/>

Select the Application from the Applications list

The Assessment Transactional System is in Consolidated Collections

Applications

You have been granted access to the items displayed in this list. To access an application, select it from the list.

- [Accountability Warehouse Extract - Oregon Department of Education](#)
- [Achievement Data Insight - Oregon Department of Education](#)
- [Consolidated Collections - Oregon Department of Education](#)
- [Secure Assessment Reports 2.0 - Oregon Department of Education](#)

Assessment Transactional System (ARUA)

ARUA - Assessment Transactional System - Assessment Test Staging (DSA)

ARUA is used to:

- Manage current year's official test records: reviewing virtual records, adding administration codes to records, and fixing records in the error queue
- To manage test records in this collection
 - You must be logged in at the school district level, and
 - Students must be reported as a resident of your district at the time of testing
- Review AA Checklist for training dates and see "Reporting of Statewide Assessment Results" table on page 50 for test record loading schedule
<https://www.oregon.gov/ode/schools-and-districts/Documents/asmtacctbltychecklist2425.pdf>

Assessment Transactional System (ARUA) 2

Record Management/Edit Posted Records

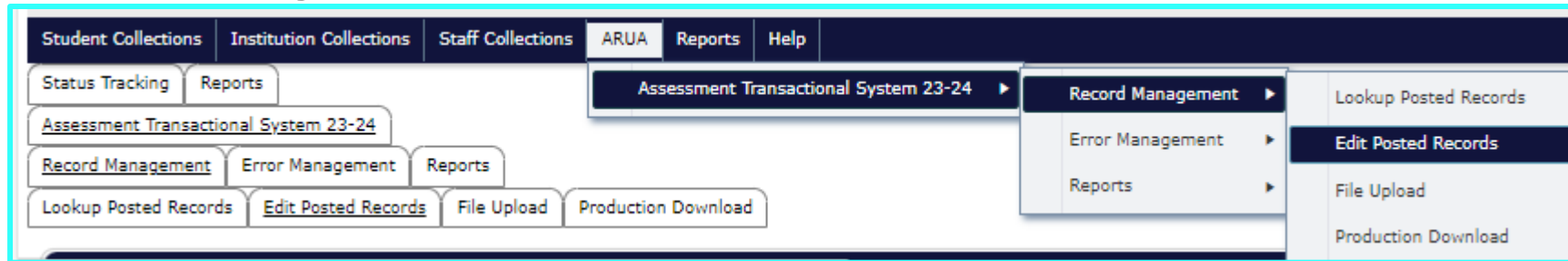

Academic Year	<input type="text" value="20232024"/>	Test Year	<input type="text" value="2324"/>	Test End Date	<input type="text" value="04/22/2024"/>
PADMID	<input type="text" value="60111807T0424"/> *	Subject Code	<input type="text" value="CM"/>	Test Type Code	<input type="text" value="T"/>
Overall Scale Score	<input type="text" value="2503"/>	Performance Level for Grade	<input type="text" value="1"/>	Performance Level for Benchmark	<input type="text" value="1"/>
ELPA Proficiency Status Code	<input type="text"/>	Test Benchmark Code	<input type="text" value="4M"/>	Test Grade Band Code	<input type="text"/>
Test Valid Flag	<input checked="" type="checkbox"/> Y <input type="checkbox"/> N	Test Attempted	<input type="text" value="Y"/>	Enrolled Grade At Test	<input type="text" value="11"/>
Best Score Flag	<input checked="" type="checkbox"/> Y <input type="checkbox"/> N	Targeted Code	<input type="text"/>	Administration Code	<input type="text"/>
Accommodation Flag	<input type="checkbox"/> Y <input type="checkbox"/> N <input checked="" type="checkbox"/> *	Accommodation Code 2	<input type="text"/>	Accommodation Code 3	<input type="text"/>
Accommodation Code 1	<input type="text"/>	Accommodation Code 5	<input type="text"/>	Accommodation Code 6	<input type="text"/>
Accommodation Code 4	<input type="text"/>	Class Period	<input type="text"/>		
Teacher Name	<input type="text"/>				

Assessment Transactional System (ARUA) 3

The ARUA application has a Test Lookup Report that can be used to:

- Look up summative test records taken in Oregon (2019-20 through 2024-25)

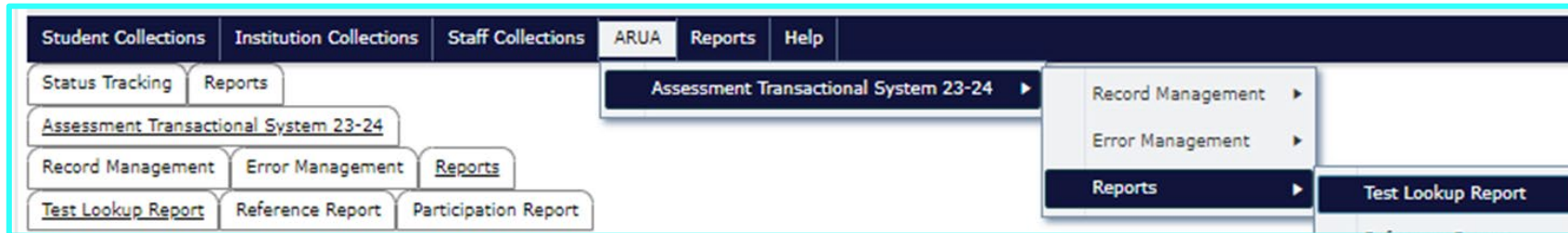

Status	SSID	First Name	MI	Last Name	Resident District ID	Resident District Name	Resident School ID	Resident School Name	Subject	Bench	Test Type	Test Valid Flag	Test Date
Posted						Silver Falls SD 4)	780	Pratum Elementary School	CE	2B	T	Y	052022
Posted						Silver Falls SD 4)	780	Pratum Elementary School	CM	2B	T	Y	052022
Posted						Silver Falls SD 4)	780	Pratum Elementary School	NS	2B	T	Y	052022

Secure Assessment Reports (SAR)

The SAR application provides access to official summative test scores in pdf format

- Individual Student Reports (ISR)
- Combined ISR
- Class Roster
- Class Summary

Districts are required to report student progress to families annually ([OAR 581-022-2270](https://www.oregon.gov/DEQ/ELPA/581-022-2270))

Reminder: Obtain 2022-23 and 2023-24 Alt ELPA results from your Regional ESD partner.

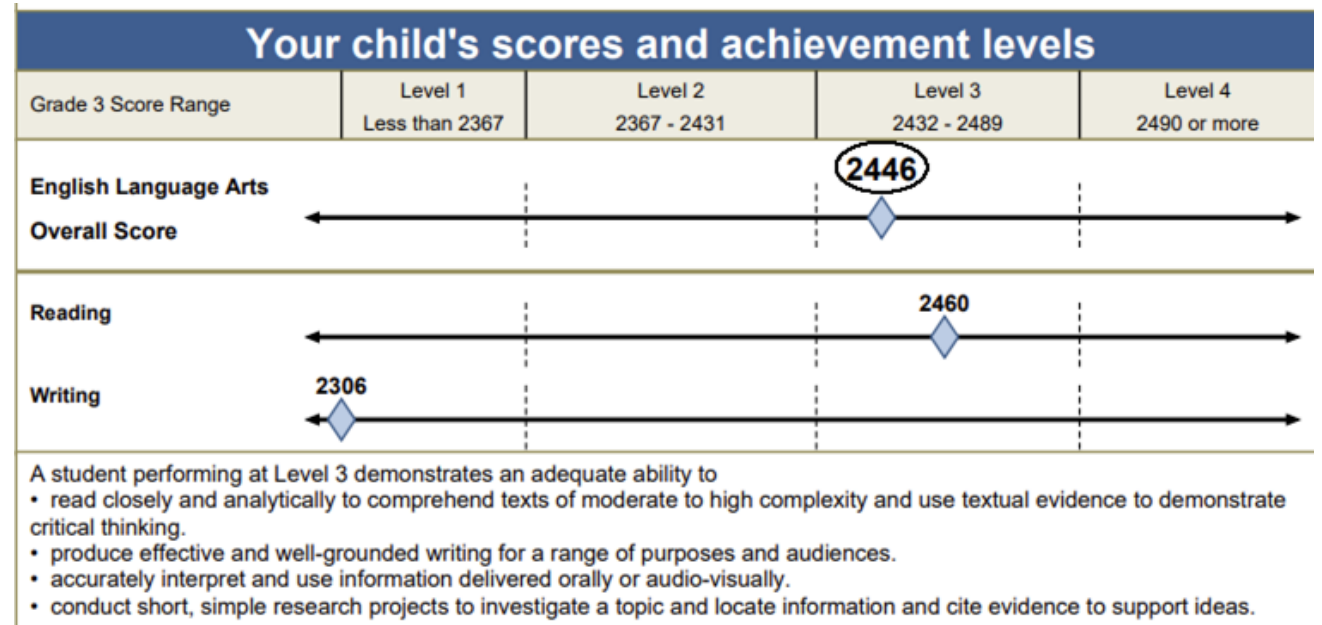

Achievement Data Insight (ADI)

The ADI application is used to view validation data that ODE summarizes for accountability reporting, in this case, assessment student performance summaries. ODE summarizes participation and performance data in three validations

English Language Arts Student Performance	Mathematics Student Performance	Science Next Gen Student Performance
<u>Last Visited:</u> 10/10/2024	<u>Last Visited:</u> 11/20/2024	<u>Last Visited:</u> 11/20/2024
<u>Last Refreshed:</u> 09/11/2024	<u>Last Refreshed:</u> 09/11/2024	<u>Last Refreshed:</u> 09/11/2024
<u>Validation Open:</u> 06/13/2024	<u>Validation Open:</u> 06/13/2024	<u>Validation Open:</u> 06/13/2024
<u>Validation Closed:</u> 08/23/2024	<u>Validation Closed:</u> 08/23/2024	<u>Validation Closed:</u> 08/23/2024
<u>Public Release:</u> 11/21/2024	<u>Public Release:</u> 11/21/2024	<u>Public Release:</u> 11/21/2024
Closed	Closed	Closed

On-Track to English Language Proficiency

2024-25 Validation Window 7/24/25-8/22/25

- ❖ Data is embargoed until the public release date.

On-Track to English Language Proficiency
<u>Last Visited:</u> 08/23/2024
<u>Last Refreshed:</u> 09/11/2024
<u>Validation Open:</u> 07/18/2024
<u>Validation Closed:</u> 08/23/2024
<u>Public Release:</u> 11/21/2024
Closed

Achievement Data Insight (ADI) 2

2024-25 English Language Arts, Mathematics, Science Next Gen Student Performance validations

- Open June 12 and close August 22, 2025
- Participation calculation includes students enrolled on the first weekday in May
- Performance calculation includes students enrolled for a full academic year (enrolled on the first weekday in May and greater than .5 calculated ADM FTE)
 - Achievement/Performance Standards <https://www.oregon.gov/ode/educator-resources/assessment/Documents/asmtachstdsummary.pdf>
- ❖ Ensure Principals have a chance to review the validations before they close. If the summaries are not correct, action is required by the school district. The last day to make changes is August 22.

Accountability Warehouse Extract (AWE)

The AWE application allows users to download historical summative test data for students they have claimed, regardless of where the test was taken in Oregon, in CSV or Excel format

- Assessment Bulk Extract
- Assessment Student Extract

The file is 156 columns wide

File format document:

<https://odedistrict.oregon.gov/CollectionsValidations/FileFormats/Documents/asmtreportingfileformat.xlsx>

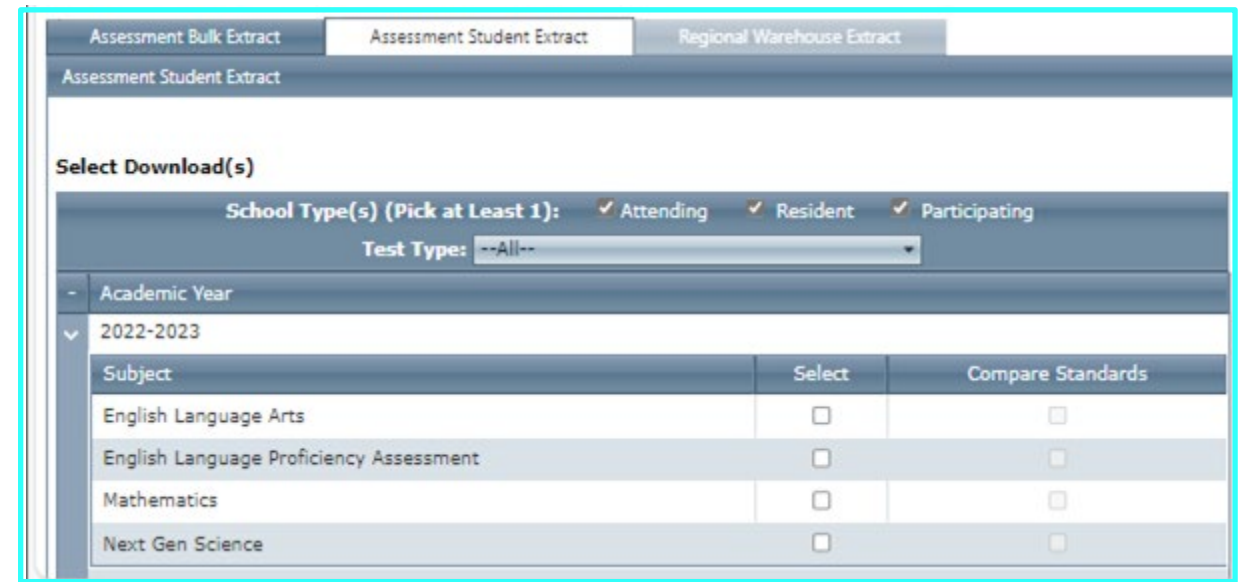

The screenshot shows the 'Assessment Student Extract' interface. At the top, there are three tabs: 'Assessment Bulk Extract', 'Assessment Student Extract' (which is active), and 'Regional Warehouse Extract'. Below the tabs, the title 'Assessment Student Extract' is displayed. The main area is titled 'Select Download(s)'. It features two filter sections: 'School Type(s) (Pick at Least 1):' with three checked options: 'Attending', 'Resident', and 'Participating'; and 'Test Type:' with a dropdown menu set to '--All--'. Below these filters is a table with columns for 'Subject', 'Select', and 'Compare Standards'. The table is filtered for the academic year '2022-2023'. The subjects listed are English Language Arts, English Language Proficiency Assessment, Mathematics, and Next Gen Science, each with an unchecked checkbox in the 'Select' column and an unchecked checkbox in the 'Compare Standards' column.

Subject	Select	Compare Standards
English Language Arts	<input type="checkbox"/>	<input type="checkbox"/>
English Language Proficiency Assessment	<input type="checkbox"/>	<input type="checkbox"/>
Mathematics	<input type="checkbox"/>	<input type="checkbox"/>
Next Gen Science	<input type="checkbox"/>	<input type="checkbox"/>

Public Assessment Group Reports

Many district staff ask for Assessment summary results they can share

- <https://www.oregon.gov/ode/educator-resources/assessment/Pages/Assessment-Results.aspx>
 - Excel summaries that include students who are reported as residents on first weekday in May
[English Language Arts](#)

Data is embargoed until the public release date.

23-24 PAGR data was available to the public on 11/1/24

All Performance Levels (including Participation)

These files show the performance percent at each level, as well as the participation rate, for the grade levels and student groups listed.

School Year 2023-2024 ✕

- [State Level, All Grades, All Student Groups](#)
- [District Level, All Grades, All Student Groups](#)
- [School Level, All Grades Combined, All Student Groups](#)
- [School Level, Grades 3-8 & HS, Race/Ethnicity, Total Population \(All Students\)](#)
- [School Level, Grades 3-8 & HS, Students Experiencing Poverty, Homeless, Military-Connected, Students in Foster Care, Total Population \(All Students\)](#)
- [School Level, Grades 3-8 & HS, English Learners, Indian Education, Migrant Education, Talented and Gifted \(TAG\), Total Population \(All Students\)](#)
- [School Level, Grades 3-8 & HS, Extended Assessment, Students with Disabilities \(SWD\), SWD with Accommodations, Total Population \(All Students\)](#)
- [School Level, Grades 3-8 & HS, Gender \(Female, Male, Non-Binary\), Total Population \(All Students\)](#)



Q&A



Thank You!

Feedback Form

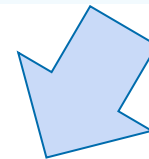
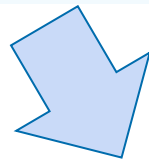

Please give us [your feedback](#) and suggestions for next session!